

PAYMENT TERMS & OTHER DETAILS:

- a) 10% at the time of booking
- b) Remaining installments as finalized at the time of booking (As per RERA)
- c) **Additional Payments towards allotment of Unit:**
 - **AMC/UGVCL and Legal:**
 1. Lump sum Rs.1050/- per sq.ft. (Rs.11307/- per sq.mtr.) of Carpet area is payable at the time of possession towards AMC / UGVCL and legal charges.
 - **Maintenance Charges:**
 2. Rs. 5/- per sq.ft. (Rs 54 per sq.mtr.) of Carpet area per month for 24 months is payable at the time of possession towards maintenance expenses
 3. Stamp duty, registration fees, legal charges etc. as applicable at the time of possession
 4. Additional amount payable on delayed payments @ 1% per month up to a delay of 3 months. If delay is more than 3 months, the booking will be automatically cancelled
 - GST is payable additionally at the time of installments only on all payments at applicable rate
- d) Please refer layout plan for situation, size and nomenclature of the unit
- e) All first-floor apartments are allotted open terrace
- f) All plans, specifications, designs, elevations, features, amenities, facilities and services mentioned are indicative of the kind of development proposed. All transactions shall be subject to the terms and conditions of the Agreement for sale to be entered into between the concerned parties

OTHER INFORMATION

- All Payments in favour of “**Synthesis Spacelinks Pvt. Ltd - Altius Vibe**”
- Variation in shades, sizes and levels are likely in Italian marble, Vitrified tiles, ceramic tiles, marble and granite due to constraints of availability and manufacturing.

LOWER BASEMENT PLAN

Cars
Two Wheelers

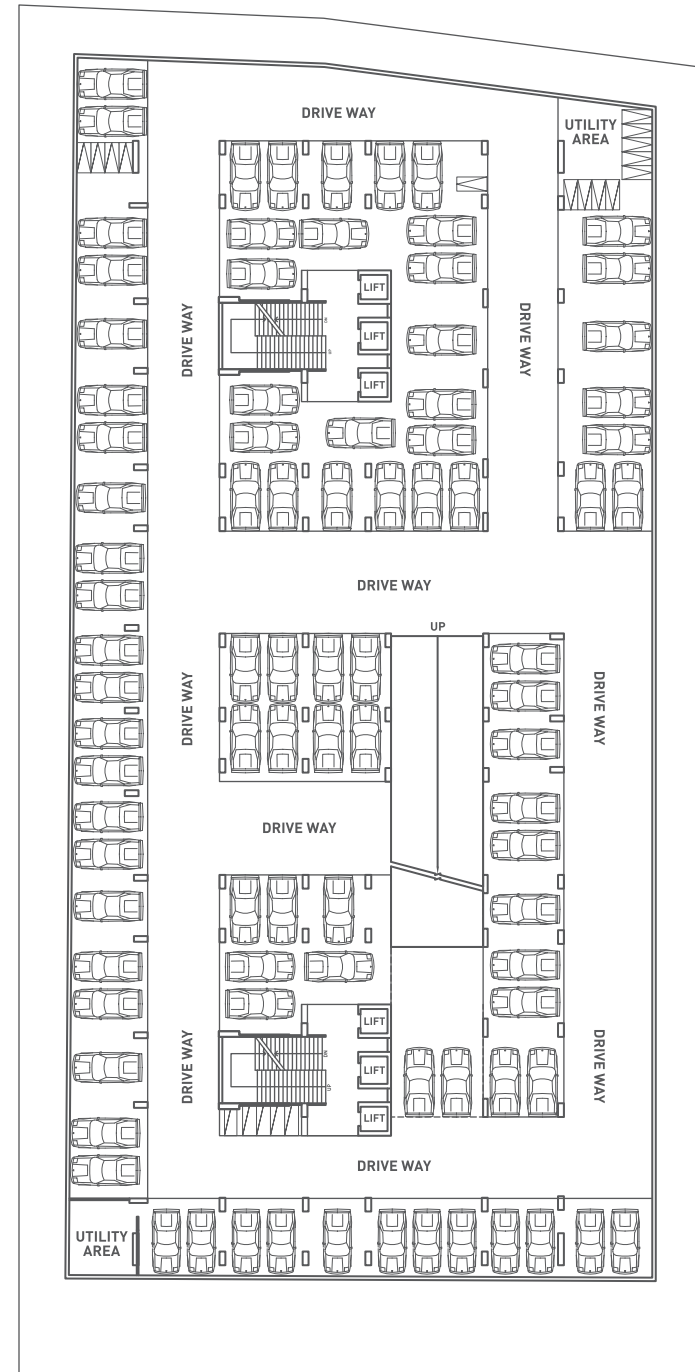

UPPER BASEMENT PLAN

Cars
Two Wheelers

